



E-STILTS

Simple and Ingenious





I N T R O D U C T I O N

Inspired by stilts house – a pile dwelling that come with raised structure, and normally built over sand or above water, “E-Stilts” is created as our new leg. As found in Wikipedia, “Stilts” are pillars or posts to allow a structure to stand at a height above the ground, “E-Stilts” has come up to act as a desking system. Stilts house which is easy to construct and protect against nature elements of flood and earthquake applies to E-Stilts understructure. It act as a pile driver of strength on its foundation.

E-Stilts act as a simple, ingenious, and adaptive bench, for entire range of application in open workplace. It is a reconfigurable bench and suitable for any demands of office environment. On this basis, E-Stilts is offering a great flexibility to work across a wide range of configuration demands, from staff workstation to manager workstation and conference table.



Good



T A B L E O F CONTENTS

03 - 05	Linear Workstation
06	L-Shaped Workstation
07 - 08	120 Degree Workstation
09 - 10	Executive Work Desk
11 - 13	Conference Table
14	Discussion table
15	Bar Table
16	Waiting Area
17 - 18	Wire Management
19	Flexible & Efficiency Reconfiguration Understructure
20	Details
21	Options
22	Certificates
23 - 24	Project References
25 - 26	Client List

LINEAR WORKSTATION

E-Stilts bench design allows 2 or more people to work together without losing their personal space. It integrated personalized work tools and storages on table tops, allow individuals to access it easily.

- Worktop Colour** : American White Ash
- Cabinet Colour** : American White Ash
- Epoxy Colour** : White
- Privacy Panel** : Morton 9338 Summer Lime
- Chair Model** : Xenic

Dimension:

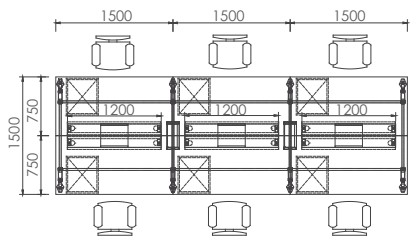

Other Configurations:





LINEAR WORKSTATION

Teams need places that allow them to see their teammates comfortably, hear each other clearly and share information easily in order to build social capital and the "shared mind" that is necessary to bring innovation to successful conclusion. E-Stilts design offers a comfortable place to work, focus and maximise interaction between each other.

Worktop Colour : American White Ash

Cabinet Colour : American White Ash

Epoxy Colour : White

Privacy Panel : Frosted Glass

Chair Model : Xera

Dimension:

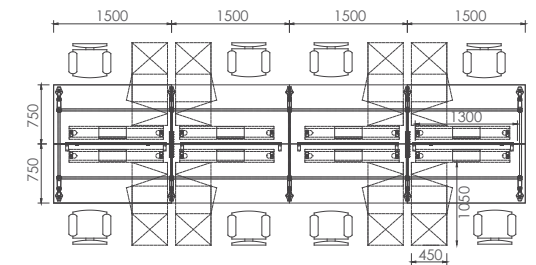

Other Configurations:



LINEAR WORKSTATION

A minimalistic and simple office helps people to concentrate and clear their minds. E-Stillts designed with minimal components to provide more leg movement spaces. It completes with TrendX Pro hanging fabric panel that not only acts as privacy screen but also as modesty panel.

Worktop Colour : Marinus Walnut

Cabinet Colour : Marinus Walnut & White

Epoxy Colour : White

Privacy Panel : Platinum P16 Laguna

Chair Model : Xenic

Dimension:

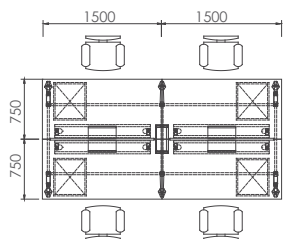

Other Configurations:





L-SHAPED WORKSTATION

Versatile working scenarios with add-on table for additional surface space and storage unit as storage space for documents with modern style and simple modularity that delivers on form and functions.

Worktop Colour : Rochelle White

Cabinet Colour : Rochelle White

Epoxy Colour : White

Privacy Panel : Morton 9585 Citrus Orange

Chair Model : Xenic

Dimension:

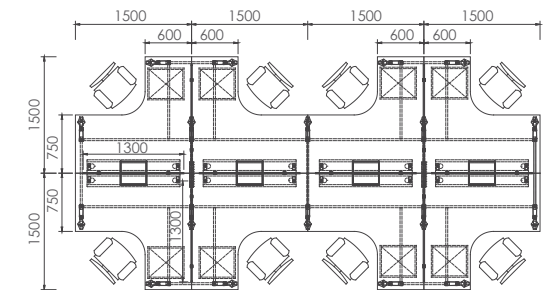

Other Configurations:

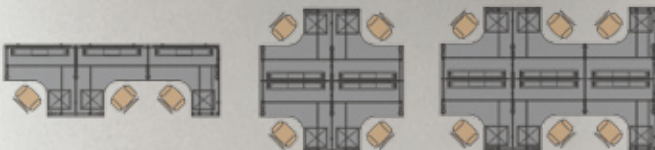

120 DEGREE WORKSTATION

E-Stils 120 degree planning design system can create higher workstation densities to optimise office layout, that help employees engage and amplify the performance of people, teams and organizations.

Worktop Colour : Murnau Maple

Epoxy Colour : White

Privacy Panel : BZ46 Orange

Chair Model : Xenic

Dimension:

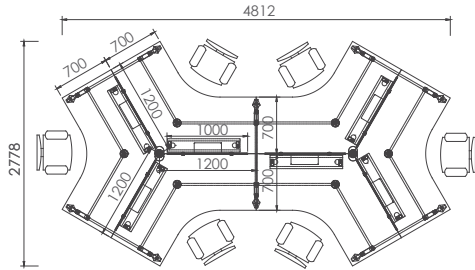

Other Configurations:

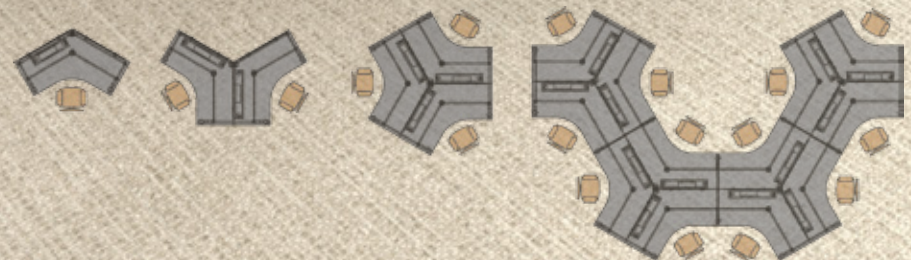



120 DEGREE *WORKSTATION*

E-Stills 120 degree workstation creates informal and sociable feel in workplace, provides greater amount of workspace, storage and collaboration working environment. It also creates a comfortable working environment in which the tools we need are always within reach.

Worktop Colour : Snow White

Epoxy Colour : Champagne

Privacy Panel : Morton 9440 Cloud Dancer

Chair Model : Xera

Dimension:

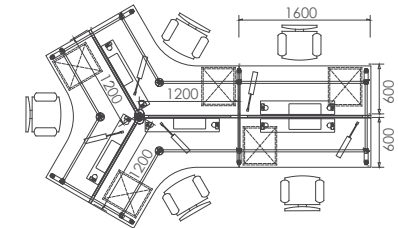

Other Configurations:



EXECUTIVE WORK DESK

E-Stillts combines the sophisticated quality of refined design and fine wood craftsmanship with the convenient integration of electrical technologies. Its bring styles and sophistication to modern office.

Worktop Colour : American White Ash

Cabinet Colour : American White Ash

Epoxy Colour : White

Chair Model : Xenic

Dimension:

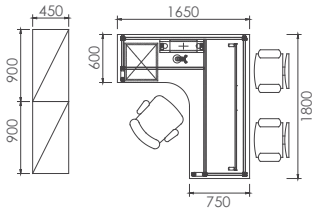

Other Configurations:





EXECUTIVE WORK DESK

E-Stills was designed with storages design creates individual working space and space saving functionality for executive to work harder and smarter. It provides a range of applications to support collaborative and individual work.

Worktop Colour : Marinus Walnut

Cabinet Colour : Marinus Walnut

Epoxy Colour : White

Chair Model : Bueno

Dimension:

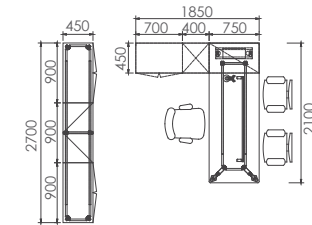

Other Configurations:

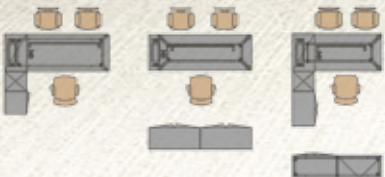

CONFERENCE TABLE

E-Stillts is designed for all level of communication and management tasks, equipped with the center wire riser box, all power and data cables are integrated into the central of table and neatly kept. The intelligent design of wire riser box also minimize the number of table legs and optimize user comfort.

Worktop Colour : American White Ash

Epoxy Colour : White

Chair Model : Supremo

Dimension:

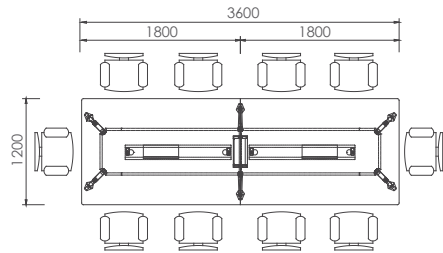

Other Configurations:





CONFERENCE TABLE

E-Stilts rectangular meeting table reflects simplicity and elegance in large meeting room. The smart designed electrification and cable management solution make E-Stilts act as a highly flexible system which can be easily reconfigured and with ample room for legs movement.

Worktop Colour : Marinus Walnut

Epoxy Colour : Black

Chair Model : Bueno

Dimension:

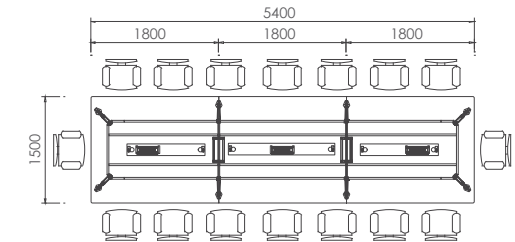

Other Configurations:



CONFERENCE TABLE

E-Stills boat shaped conference table presents modern yet contemporary concept. Its curve edges design can accommodate larger crowd yet make the room look spacious, perfectly for professional meetings in a conference room. The table comes with easy data access and power supply connection application to allow people comfortably with their electrical assets.

Worktop Colour : Havana Oak

Epoxy Colour : White

Chair Model : Supremo

Dimension:

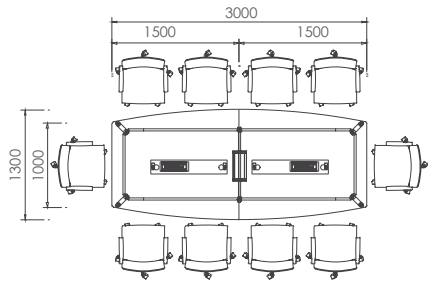

Other Configurations:





DISCUSSION TABLE

E-Stilts discussion table suits for office group discussion or staff café. It is complemented with wooden top or glass top with various table shapes and numerous table top colours, to ensure a unique and great impression look.

Worktop Colour : Glass & Marinus Walnut

Epoxy Colour : Light Grey

Chair Model : Supremo

Dimension:

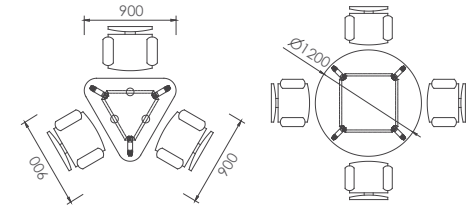

Other Configurations:

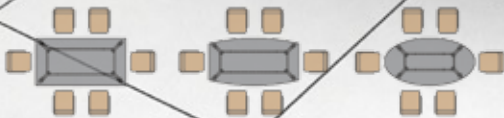

BAR TABLE

E-Stills creates ecosystem with palette of posture-spaces that encourage people to sit, discuss, stand and move through their day, while supporting the different kinds of work they do.

Worktop Colour : Olive Ash

Epoxy Colour : White

Chair Model : Stool

Dimension:

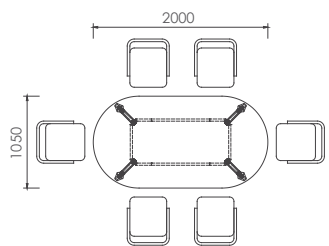

Other Configurations:





WAITING AREA

E-Stilts bench was created to solve the challenges of today's waiting places. A modular system that can be reconfigured in many ways for many applications.

Epoxy Colour : White

Seating : Vertex 1818-23 Martique

Dimension:

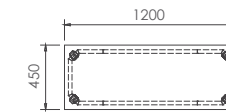
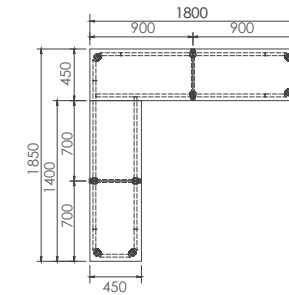

Other Configurations:



WIRE MANAGEMENT

Intelligent designed wire management solution makes E-Stilts neat and easy to route power and data up to workspace.

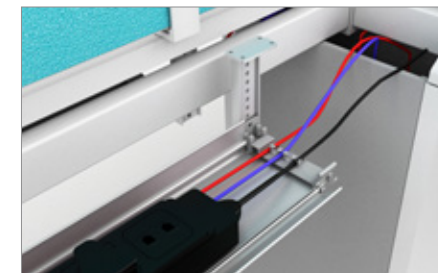

Aluminium wire tray drives wires underneath the desk and uses metal wire riser box for storing massive wires, creates effective wire management solutions in workplace.



There is an optional way to route wires to table top, via E-Stilts table leg. This is ideal for executive workstation whose wire is small in capacity.

WIRE TRAY



Single metal wire tray



Double metal wire tray



Single basket wire tray



Single aluminium wire tray

FLIP UP DOOR



Aluminium flip up door



Aluminium flip up door with press button

WIRE RISER

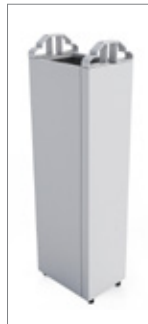

Metal wire riser box
L210 x D160
(Small)



Metal wire riser box
L340 x D160
(Medium)



Metal wire riser box
L490 x D160
(Large)



I-Beam aluminium wire riser (attach to top)



I-Beam aluminium wire riser (attach to table beam)



Metal wire riser (attach to top)



Metal wire riser (attach to table leg)



Wire conduit

FLEXIBLE & EFFICIENCY RECONFIGURATION UNDERSTRUCTURE

ONE SIZE DOESN'T FIT ALL

In table top extension, E-Stilts can be extended in length of L150 and L300. This table top extension function normally is applicable for conference table.



PRACTICE SOLUTION TO CATER MANY DIFFERENT NEEDS AND BEHAVIORS

Add-on table without removing the existing table top. This table extension function normally is applicable for staff workstation in linear and L-shaped.

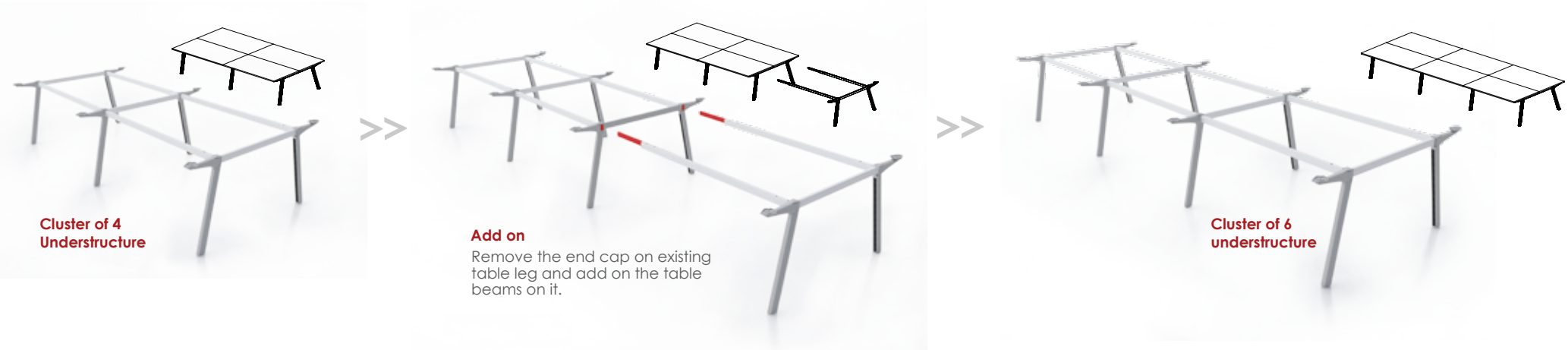

DETAILS

LEG PROFILE



Slant leg with table arm

Straight leg with table arm

Slant and straight leg with table arm

Slant leg

Straight leg

Slant and straight leg

LEVELER



Manual regulation leg that can be adjusted by just using a screwdriver.

ADJUSTABLE LEG



E-Stilts system also act as height adjustable table to allow people to adjust the height for table up to 150 mm.

LEG ANGLES



45 Degree

90 Degree

TABLE ARM

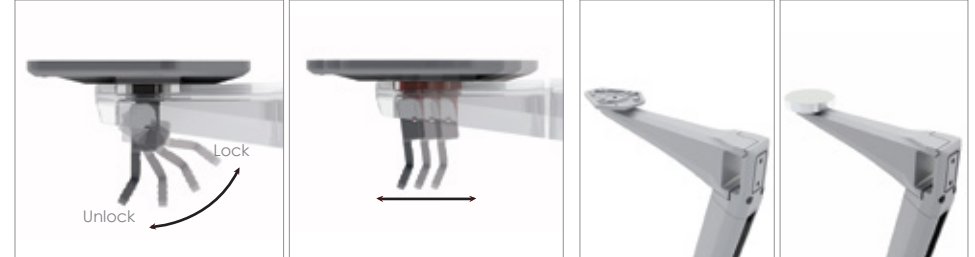

E-Stilts table arm come with locking mechanism, to attach to table top without bolts and nuts with approximately 10 mm of free movement. This table arm also can be applied in Trendx Pro System.

Table arm for wooden top

Table arm for glass top

OPTIONS

TRENDX PRO PANEL

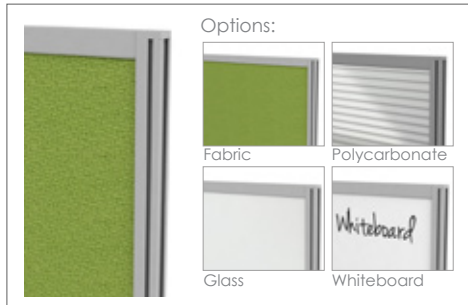

- TrendX Pro panel is a 22mm thickness panel with aluminium extrusion frame.
- It hangs on the table top acts as a privacy screen, creating a partition while keeping the space open.
- Panel upholstery options: fabric, pinnable fabric, glass, whiteboard, magnetic whiteboard, polycarbonate and accessories rail.

I-BEAM PANEL

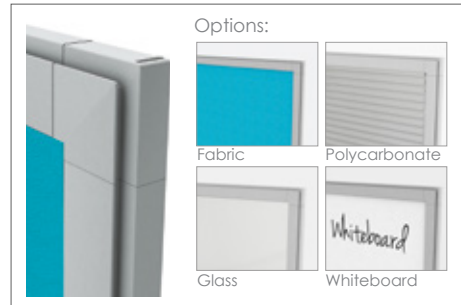

- I-Beam screen is a groove edge designed 18 mm thickness screen.
- I-Beam panel upholstery options: fabric, pinnable fabric, glass, whiteboard, glass whiteboard, polycarbonate and accessories rail.

IF PANEL

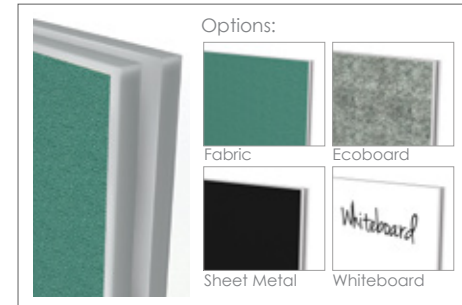

- IF panel is a slim 18 mm panel with frameless design.
- IF panel upholstery options: fabric, ecoboard, sheet metal and whiteboard.

MODESTY PANEL



- A modesty panel is designed to conceal person legs seated at and presents beauty.
- It available in a range of sizes, depending on the table shape, size and how much concealment is required.
- Modesty panel options: netting, metal perforated, frosted glass and wooden.

ACOUSTIC PAD



- A 18 mm thickness acoustic pad, available in 4 colour options: green, blue, grey and orange.
- Standard dimension: Height: H340 mm Length: L450 mm – L1800 mm
- The panel length can be reduced or extended with limitation of 150 mm each time.
- Its ideally lengths are 1800 mm & 900 mm, any wastage consumption will be charged in full.

GLASS DIVIDER SCREEN

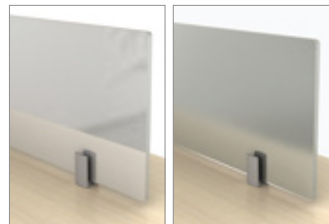

Clear Glass Screen Frosted Glass Screen

- A 8 mm thickness laminated glass screen, available in clear or frosted glass.

FABRIC DIVIDER SCREEN

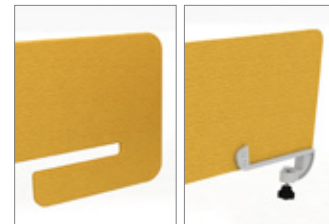

Fixed Divider Screen Adjustable Divider Screen

- Fixed divider screen is a 22 mm thickness fabric screen with PVC lining.
- Adjustable divider screen is a 8 mm thickness fabric screen with rubber lining. It come with adjustable divider bracket.

PANEL TRACK

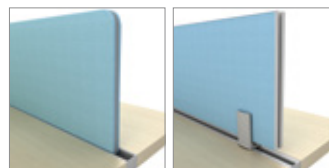

For Fabric Divider Screen For IF Screen

- Panel track that provide panel mounting options.

WORKSURFACE

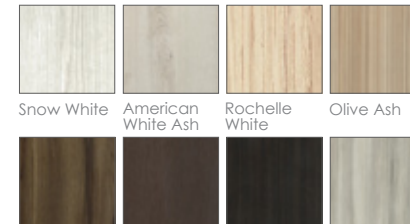

Snow White American White Ash Rochelle White Olive Ash

- Available worksurface options: MFC, HPL and high gloss.
- Available worksurface edging options: flat and reverse chamfered.



Flat Reverse chamfered

EPOXY COLOUR

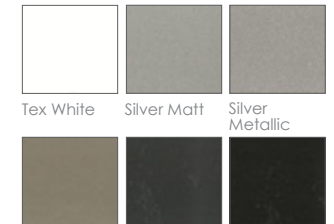

Tex White Silver Matt Silver Metallic

- All of the leg structures and panel frames are come with epoxy coating to protect the structure from rusty and give it to a clear and glossy look.
- Epoxy colour options: tex white, silver matt, silver metallic, champagne, graphite and black.

Disclaimer: 1. All images are for illustration purposes only.
2. Colour shown may not be an accurate representation of the actual colour, please refer to actual colour samples for final confirmation.

CERTIFICATES

FIRA CERTIFICATE



Test Certificate

A BM TRADA Company

This certificate confirms that the
ARTMATRIX E-STILTS DESKING SYSTEM
supplied by
ARTMATIRX TECHNOLOGY SDN BHD

has been tested by TÜV SÜD PSB Pte Ltd, on behalf of FIRA International Limited,
and successfully satisfied the applicable test requirements from:

ANSI/BIFMA x5.5: 2014 "Desk/Table Products – Tests"

TÜV SÜD PSB Report reference: 7191111812-EEC15-CSL
FIRA Certificate reference: TAPS00677

SIGNATURE:  Howard James
POSITION: Operations Manager – Testing Services
CERTIFICATE DATE: 11th May 2015

For and on behalf of FIRA INTERNATIONAL LIMITED



FIRA
A BM TRADA Company

FIRA International Ltd Maxwell Road, Stevenage, Hertfordshire SG1 2EK, England.

This certificate only relates to the sample(s) supplied and tested at the time. Re-testing at intervals is recommended and should be subject to agreement between the supplier and the purchaser.

SGBPLS CERTIFICATE



SINGAPORE GREEN BUILDING PRODUCT LABELLING SCHEME CERTIFICATE

Certificate No. G00248

Certificate Holder : Artmatrix Technology Sdn. Bhd.
Lot 32789, Jalan 5/1A, Taman Perindustrian Selesa Jaya,
Balakong, Selangor Darul Ehsan,
43300 Malaysia.

Certification Mark : 

Product : Modular Furniture System & Seating
Brand Name : Artmatrix
Model(s) : E-Stilts (Eco)
Rating : Good
Standard(s) : PAG-01-MFS-0017-00
Country of Origin : Malaysia
Test Record(s) : SIRIM-COC 0068
Issued on : 2016-02-05
Valid until : 2018-02-04

This product was assessed according to the evaluation criteria of Singapore Green Building Product Labelling Scheme.

✓ Good ✓✓ Very Good ✓✓✓ Excellent ✓✓✓✓ Leader

 Vice President (Certification)
 TÜV SÜD PSB Pte Ltd

Page 1 of 1

This Certificate is part of a full report and should be read in conjunction with it. This Certificate remains the property of TÜV SÜD PSB Pte Ltd and shall be returned upon request. The use of this Certificate is subject to the Singapore Green Building Product Labelling Scheme Terms and Conditions. The manufacturer is solely responsible for compliance of any product that bear the same designation as the product type named. Persons relying on this certificate should verify its validity by checking TÜV SÜD PSB's website at www.tuv-sud-pbs.sg or SGBPLS website at www.sgbpls.sg.

TÜV SÜD PSB Pte Ltd • 1 Science Park Drive • Singapore 118201

GECA CERTIFICATE

ENVIRONMENTAL CHOICE AUSTRALIA LICENCE

Good Environmental Choice Australia Limited (GECA) manages a Type 1 Ecolabel program in accordance to ISO 14024 "Environmental Labels and Declarations" and is the owner of the Environmental Choice Australia Ecolabel.

A licence for the use of the Ecolabel is granted to a product where it has been verified by an independent conformity assessment body that the product meets the environmental performance criteria of a GECA standard.

License number: ARX-2014

Issued to: Artmatrix Technology Sdn Bhd

Issue date: 14 February 2014

Licensee since: 4 March 2011

Certified products:

E-Stilts (ECO) Desking System (9CS)	Maxim A (ECO) Tilt System (9MA)
I-Beam (ECO) Desking System (9IB)	Simplex (ECO) Monolith Panel System (9SP)
IF (ECO) Intelligent Folding Table (9IF)	Trend X (ECO) Desking System (9TF)
I-Mode (ECO) Desking System (9IM)	Tri-X Plus (ECO) Monolith Panel System (9TX)
Max-I (ECO) Pole System (9MI)	Xenic Chair

GECA standard: GECA 28-2006 (Modified 2020) v2. Furniture and Fixings

Address of head office: Lot 32789, Jalan 5/1A Selangor Darul Ehsan 43200 MALAYSIA

Conformity assessment by: BSI Group

License expiry date: 4 March 2017

 Barry Gordon
 Chief Operating Officer
 Suite 302, 25 Balwyn Street, SURREY HILLS NSW 2030
 P: +612 9699 2850 ABN: 21 138 768 153



Good Environmental Choice Australia
 Transforming the actions of business & consumers to drive a substantial increase in the sustainability of consumption

PROJECT REFERENCES



UBER MALAYSIA SDN BHD

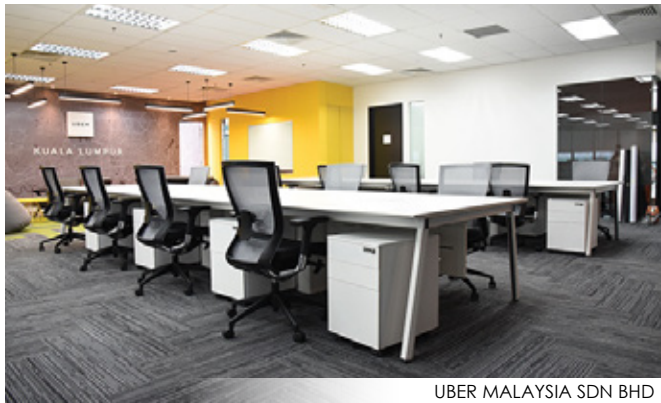

UBER MALAYSIA SDN BHD



UBER MALAYSIA SDN BHD



UBER MALAYSIA SDN BHD



UBER MALAYSIA SDN BHD



UBER MALAYSIA SDN BHD



BOEING ASIA PACIFIC AVIATION SERVICES PTE LTD, SINGAPORE



BOEING ASIA PACIFIC AVIATION SERVICES PTE LTD, SINGAPORE

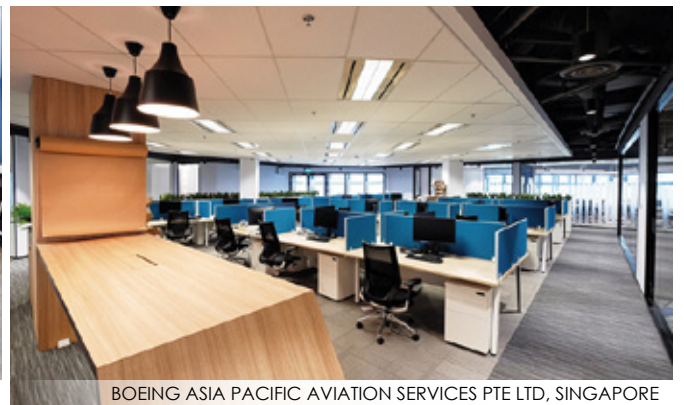

BOEING ASIA PACIFIC AVIATION SERVICES PTE LTD, SINGAPORE



UNIVERSITY OF READING MALAYSIA



UNIVERSITY OF READING MALAYSIA



UNIVERSITY OF READING MALAYSIA



UNIVERSITY OF READING MALAYSIA

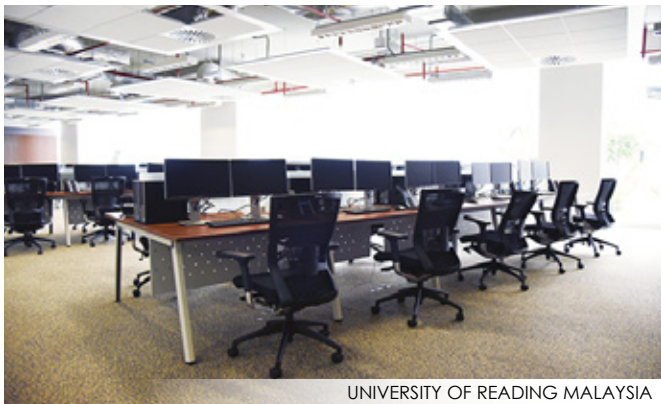

UNIVERSITY OF READING MALAYSIA



UNIVERSITY OF READING MALAYSIA



LF LOGISTIC (S) LIMITED, SINGAPORE



LF LOGISTIC (S) LIMITED, SINGAPORE



LF LOGISTIC (S) LIMITED, SINGAPORE

MALAYSIA

ABB Malaysia Sdn Bhd
 AbbVie Sdn Bhd
 Advantech CO. Malaysia Sdn Bhd
 AECOM Perunding Sdn Bhd
 Affin Bank Berhad
 Agoda International (M) Sdn Bhd
 Agro Bank Berhad
 AIA Shared Services Sdn Bhd
 Aker Engineering Malaysia Sdn Bhd
 Alam Swiber Offshore (M) Sdn Bhd
 Al-Madinah International University
 Alliance Bank Malaysia Berhad
 Allianz Malaysia Berhad (HQ), KL Sentral
 AMP Corporation (M) Sdn Bhd
 Apex Investment Services Berhad
 Applied Integrators Sdn Bhd
 Arvato Systems Malaysia Sdn Bhd
 Ar-RahnuYaPEIM
 Arup Jururunding Sdn Bhd
 Atos Origin Services (M) Sdn Bhd
 Australian High Commission
 Axon Solutions Sdn Bhd
 Bae Systems
 Bae Detica Malaysia
 Bank Islam Malaysia Berhad
 Bank Pembangunan Malaysia Berhad
 Bukit Bintang City Centre (BBCC)
 SME Bank
 Bank Muamalat Malaysia Berhad - Sabah
 Bank Kerjasama Rakyat Malaysia Berhad
 BHP Billiton Shared Services Sdn Bhd
 Binastra Construction Sdn Bhd
 Blackmores (Malaysia) Sdn Bhd
 BMW Malaysia Sdn Bhd
 Bosch
 British International School, KL
 Bursa Malaysia Berhad
 Carigali Hess Operating Company Sdn Bhd
 Carlsberg Brewery Malaysia Berhad
 CCM Chemicals Sdn Bhd
 CIMB Bank Berhad
 C.I.S Network Sdn Bhd
 Citizen Sales & Gallery
 Cochlear Malaysia Sdn Bhd
 CROPS for the Future Research Centre
 Damansara Realty Berhad
 Danajamin Nasional Berhad
 DATAFM Sdn Bhd
 Deleum Berhad
 Deloitte Malaysia
 Dewan Bandaraya Kuala Lumpur (DBKL)
 Dialog Group Berhad
 DKLS Equity Sdn Bhd
 DNP Property Management Sdn Bhd
 Dutch Lady Milk Industries Berhad
 DVM Innovate Sdn Bhd
 EC Harris
 Eco Majestic Sdn Bhd

Eco Meridian Sdn Bhd
 Eco Tropics Development Sdn Bhd
 EcoWorld International Centre
 Elken Service Sdn Bhd
 Electrolux Home
 Elegant Aura (M) Sdn Bhd
 EPF Learning Centre
 EUPE Kemajuan Sdn Bhd
 Exact Asia Development Centre Sdn Bhd
 Expedia, KL
 Export-Import Bank of Malaysia Berhad (EXIM Bank)
 Fonterra Brands (M) Sdn Bhd
 Fresenius Medical Care (M) Sdn Bhd
 F & N Dairies (M) Sdn Bhd
 General Electric International Inc.
 Getha Bedding (M) Sdn Bhd
 Gleneagles Kota Kinabalu Sabah
 Great Eastern Life Assurance (Malaysia) Berhad
 Halal Industry Development Corp Sdn Bhd
 Hawkeye International Sdn Bhd
 Hitachi Data Systems Sdn Bhd
 Hong Leong Bank Berhad
 Honda Malaysia Sdn Bhd
 HSBC Electronic Data Processing (M) Sdn Bhd
 HSBC Global Resourcing (UK) Limited
 Huawei Technologies (M) Sdn Bhd
 Int'l International Education Sdn Bhd
 Islamic Development Bank
 Istana Negara – Guest House
 Jabatan Kebudayaan dan Kesenian Negara
 Jabatan Kerja Raya Sarawak – Kuching
 Johnson & Johnson Medical Manufacturing Sdn Bhd
 Kellogg Asia Marketing Inc
 Kenanga Investment Bank Berhad
 Komatsu Asia & Pacific Pte Ltd
 Kompleks Kementerian Dalam Negeri, WPKL
 KPJ Healthcare Sdn Bhd
 Lembaga Hasil Dalam Negeri, Terengganu
 Lembaga Tabung Haji
 Lembaga Zakat Selangor
 Lubricant Business Division, PETRONAS Dagangan Bhd
 Majlis Sukan Negara
 Malaysia LNG Sdn Bhd – Bintulu
 Malaysian Agrifood Corporation Berhad (MAFC)
 Malaysian Communications & Multimedia Commission
 Malaysian Technology Development Corporation
 Mayban Fortis Holdings Berhad
 Malakoff Corporation Berhad
 Megapower
 Measat Broadcast Network System Sdn bhd
 MMC-Gamuda Joint Venture Sdn Bhd
 MNRB Holdings Berhad
 Monash Universiy Malaysia Sdn Bhd
 Nando's Chicken Office
 Naza Motor Trading Sdn Bhd
 Newcastle University
 NUMed Malaysia
 Nomad Space Sdn Bhd
 OBYU Holdings Sdn Bhd

OPPO Global Call Centre
 Padiberas NasionalBerhad (BERNAS)
 Pejabat PTPTN CawanganMenara Park
 PerbadananHartaintelek Malaysia (MyIPO)
 PerbadananUsahawanNasionalBerhad (PUNB)
 Perodua Sales Sdn Bhd
 Perwaja Steel Sdn Bhd
 Petrofac Malaysia – KLCC
 PetronasCarigali Sdn Bhd – KLCC
 Petronas Gas Berhad – Kertih
 Petronas Methanol (Labuan) Sdn Bhd
 Petronas Penapisan (Melaka) Sdn Bhd
 Petra Energy Berhad
 PharamaniagaLifescience Sdn Bhd
 Port Klang Free Zone Sdn Bhd
 POS Malaysia Berhad
 PPB Oil Palms Berhad
 Progressive Insurance Berhad
 Private Pension Administrator Malaysia
 PuncakNiaga Holdings Berhad
 Putrajaya 5G2
 -Ministry of Higher Education Malaysia
 -Ministry of Tourism Malaysia
 Putrajaya 4G8
 – Ministry of Rural & Regional Development
 Putrajaya 4G9
 – Ministry of Information, Communication & Culture
 Putrajaya 4G10
 – Ministry of Housing & Local Government
 Royal Embassy of Saudi Arabia
 Sarawak General Hospital
 Securities Commission Malaysia
 Schlumberger Wellog Sdn Bhd
 * Siemens Malaysia Sdn Bhd
 Singapore Airlines Ltd
 SIRIM Berhad
 SME Corporation Malaysia
 Sony (M) Sdn Bhd
 Sunway Group
 Sutherland Global Services
 Syarikat Bekalan Air Selangor Sdn Bhd (SYABAS)
 Tabung Haji HQ
 Talent2 Malaysia Sdn Bhd
 Talent Corporation Malaysia
 Tesco Stores (M) Sdn Bhd
 The University of Nottingham Malaysia
 TNT Express Worldwide (M) Sdn BhdTouch 'n Go Sdn Bhd
 Toyota 3E, Sibul
 Tradewinds (M) Bhd
 TSR Capital Berhad
 TWI Technology Sdn Bhd
 * Uber Malaysia Sdn Bhd
 University of Reading Malaysia, Johor
 Universiti Teknologi MARA (UiTM), Sabah
 Universiti Teknologi Malaysia-Skudai
 University Teknologi Petronas (Tronoh, Perak)
 UMW Corporation Sdn Bhd
 UM Land Builders Sdn Bhd
 UnIKI MITEC

Universiti Teknologi Malaysia (UTM)
 UOB Kay Hian Securities (M) Sdn Bhd
 Valuecap Sdn Bhd
 Volkswagen Group Malaysia Sdn Bhd
 Walton International Property Group (M) Sdn Bhd
 Warner Music Sdn Bhd
 Yinson Holdings Berhad
 YTY Industry Sdn Bhd
 Zuellig Pharma Sdn Bhd
 * Zurich Insurance Malaysia Berhad

AUSTRALIA

Commonwealth Bank of Australia
 Regus, Adelaide
 Stevens Commercial Furniture

BAHRAIN

Collage Consultants Wll

BRUNEI

Brunei Petroleum
 Malar Setia Sdn Bhd
 Ministry of Foreign Affairs and Trade
 Ministry of Education
 Ministry of Defence
 Ministry of Culture, Youth & Sports

CAMBODIA

Ramatex Holdings Bhd, Phnom Phen
 * CIMB Bank

CANADA

Distrimar Inc

INDIA

3i Infotech Ltd
 Aker Powergas Pvt Ltd
 Alstom India Ltd
 Bajaj Allianz
 Black & Veatch Consulting Pvt Ltd
 BSE Ltd
 Capgemini Hyderabad
 CBRE, Pune
 Citrix R & D India Pvt Ltd
 Cognizant Technology Solutions (CTS)
 DCB Bank
 Deloitte Communication Gym, Hyderabad
 Deloitte Consulting India Pvt Ltd
 DHL Express (India) Pvt Ltd, Mumbai
 DTDC, India
 Elkem India Pvt Ltd
 Enpro
 Esskay MEP Consultants (India)
 Financial Technologies (India) Ltd
 Fullerton Credit Company Ltd

GE, Windsor BKC
 GenesysWorldeye Ltd, Mumbai
 Glaze Granite Ltd
 Global eProcure
 Goldstar
 Hexaware Campus, Chennai
 HITOS
 HSBC
 iGate Clinical Research International Pvt Ltd
 ITB Software Service Ltd
 Ichibaan Honda Automobiles Pvt Ltd
 ICICI Bank
 Incubation Centre, Pune
 Jardine Lloyd Thompson India Pvt Ltd
 JP Morgan & Co. Inc
 Jyothy Structures Ltd, Andheri West
 KPII Technologies Limited
 Larsen and Toubro Ltd
 L'oreal India Pvt Ltd
 Lupin Ltd
 Marathon Maxima
 Mashreq Bank
 Mastek Ltd
 Max 90A Gurgaon
 Max Life Insurance Co. Ltd
 McKinsey Knowledge Centre India Pvt Ltd
 Mirae Asset global Investments Pvt Ltd, Chennai
 Morgan Stanley Capital International (MSCI) Barra
 N.Y.K. Logistics India Ltd, Andheri
 NCR Teradata, Pune
 ONGC Mangalore Petrochemicals Ltd (OMPL)
 Paternoster India Pvt Ltd
 Patni Computer Systems Ltd
 Praxis i-Technologies Pvt Ltd
 Prime Technology Group, Hyderabad
 Regus India
 Reliance – New Delhi
 Saraswat Co-operative Bank Ltd, Mumbai
 Searland Management Services (India) Pvt Ltd
 Sify Technologies Ltd, Chennai
 State Street Bank
 Sundaram BNP Paribas Fund Services Ltd
 Syntel India Ltd
 Tata Consultancy Services Ltd
 Tata Motors Ltd
 Tata Motors Finance Ltd
 Tata Capital Limited (TCL), Mumbai
 Thermax Ltd, Pune
 TNS India Private Ltd
 Transocean House
 Uhde India Ltd
 Unisource India
 Vodafone India Services Pvt Ltd
 Wirtgen India
 WNS Global Services Pvt Ltd

INDONESIA

Astra International
 Bank Saudara

Barclays Bank
 CIMB Bank
 Generali
 Mandiri Sekuritas
 MNC (Media Nusantara Citra)
 Panin Bank
 PT Pamapersada
 Telesindo

MAURITIUS

Arup Sigma Ltd
 CMA – CGM
 Euro CRM Mauritius Ltd
 Maurice Publicité
 POS
 SAB Miller
 Holiday Inn Airport Hotel

MYANMAR

Mingalarzay Office
 ShweTaung Cement Co. Ltd

QATAR

Allianz Worldwide Care, Saudi Arabia
 ICICI Bank, Doha
 Qatar Petroleum International Ltd

SINGAPORE

Baker & McKenzie.Wong & Leow
 Bank of China
 * Boeing Asia Pacific Aviation Services Pte Ltd
 BNP Paribas Private Bank
 CET Campus East
 CET Campus West
 * Changi Airport Group (\$) Pte Ltd
 Credit Agricole Corporate & Investment Bank
 Crimson Logic Pte Ltd
 Cummins Corporate Office
 Cummins Diesel Sales Corporation
 Cummins Engine (S) Pte Ltd
 Cummins Power Generation (S) Pte Ltd
 Ez-link Pte Ltd
 Gammon Pte Ltd
 Goodrich Aerostructures Service Center Asia Pte Ltd
 * Government of Singapore Investment Corporation Pte Ltd
 Great Eastern Life Assurance Co. Ltd
 Holiday Inn Park View Hotel Singapore
 John Willies & Sons
 Kalla Group
 Knight Frank Pte Ltd
 * LF Logistic (S) Ltd
 Luxasia Pte Ltd
 National Cancer Centre Singapore
 National Computer Systems Pte Ltd
 National Library

National University of Singapore
 Nestle
 Samsung
 Savi Technology Asia Pte Ltd
 Schaefer Systems International Pte Ltd
 Schroder Investment Management (S) Ltd
 Sembawang Corporation
 Sembawang Engineers & Constructors Pte Ltd
 Singapore Economic Development Board
 Singapore Press Holdings Ltd
 Straco Corporation Ltd
 Sumifru Singapore Pte Ltd
 Sungard
 The National Library Board, Library Supply Centre
 Toshiba
 Total Oil Asia-Pacific Pte Ltd
 Universal Terminal (S) Pte Ltd
 UOB Life Assurance Ltd

TANZANIA

Skylink Travel & Tours Ltd
 The Living Room Ltd

THAILAND

Ajinomoto Co.,Ltd
 Alpha Group Co., Ltd.
 B.B. Battery (Asia) Co., Ltd.
 Bangkok Business Media Co., Ltd.
 Bangkok New Trend Development Co.,Ltd.
 Chanthaburi Ploysanglighting Co.,Ltd.
 Chulalongkorn University
 Code Master Co.,Ltd.
 Dtac
 First Chapter Co.,Ltd.
 Fuji Xerox (Thailand) Co. Ltd
 Generali Insurance (Thailand) Public Co., Ltd.
 Generali Life Assurance (Thailand) Public Co., Ltd.
 Green Asset Management Co., Ltd.
 Huawei Technologies Co. Ltd
 Kasetsart University
 Millward Brown Firefly Co., Ltd.
 Mitsubishi Motor Co.,Ltd
 Netka System
 Oishi Trading Co.,Ltd.
 * Pearl Bangkok
 Pcl Holding Co.,Ltd.
 Professional Maid Co.,Ltd.
 Ptt Energy Solutions
 Robert Bosch Co.,Ltd
 Sabc Innovative Plastics Co., Ltd.
 Saengthai Rubber Co.,Ltd
 Sappakit Administration Co.,Ltd.
 Siamvarinnitkarn Co.,Ltd.
 Sigma Agrochemical Co., Ltd.
 Strabag Industries (Thailand) Co.,Ltd.
 Taweekun Instructional Media Co.,Ltd.
 Terragro Fertilizer Co., Ltd.

Thai Lube Base
 Thai Vista Enterprise Co., Ltd.
 Thailine Resources Co.,Ltd.
 Thammasat University
 The American School Of Bangkok
 The Nomad Offices, Bangkok
 Tron Co.,Ltd
 Total Access Communication Public Company Ltd
 Use Electronics (Thailand) Co.,Ltd.
 Valeo Niles (Thailand) Co. Ltd
 V-Intelligence Co.,Ltd.

UAE

Ambiante Interiors LLC
 AV Concepts LLC
 Alternative Capital Invest (ACI)
 Al Faris (Dubai and AbuDubai)
 Alstom
 Al Tayer Group
 Big Yellow Storage
 Carrefour, Dubai
 DFSA, Dubai
 DP World Ltd
 Division Nine Interior Design (LLC)
 Dubai Islamic Bank
 Dubai Municipality (Government of Dubai)
 Ducab
 Emaar
 Empire Aviation Group
 Goldline Group
 Hamptons
 JID Management Consultancy FZ LLC
 Kottoor International LLC
 Kreol Trading FZCO
 Manchester Business School
 Matrix Interiors Design LLC
 Modelcraft Pty Ltd
 Nakheel
 PCFC
 Premier Real Estate Bureau LLC
 Qanat Al Qasba Business Center
 Right Angle Media, FZ LLC
 S.S. Lootah Group
 Sify International
 Sika International Ltd
 The Independent Tobacco FZCO
 Thermax Ltd
 Zabeel Contracting Co. LLC

UGANDA

Bidco Uganda Ltd

UKRAINE

CIB Engineering

www.artmatrix.com.my



ARTMATRIX TECHNOLOGY SDN BHD (694144-X)
ARTMATRIX MANUFACTURING SDN BHD (693659-U)
Lot 32789, Jalan 5/1A, Taman Perindustrian Selesa Jaya,
43300 Balakong, Selangor, Malaysia.
☎ +603 8962 2286 ☎ +603 8961 8862
✉ sales@artmatrix.com.my
🌐 www.artmatrix.com.my

JAKARTA REPRESENTATIVE OFFICE
28-12, DBS Bank Tower 28 Floor,
Ciputra World One,
Jalan Prof. Dr. Satrio Kav 3-5,
Jakarta 12940, Indonesia.
☎ +62 21 2988 7965 ☎ +62 21 2988 8201
✉ jakartaoffice@artmatrix.com.my



ISO 9001 Certified



ISO 14001 Certified

KK SHOWROOM
Ground Floor, Block B, Lot 4,
Damai Plaza Phase 3,
Wisma CTF, Jalan Damai,
88300 Kota Kinabalu, Sabah, Malaysia.
☎ +6088 448 355 / 448 655
☎ +6088 448 455



ARK-2014
GECA 28-2008 v2
Furniture & Fittings



Prime Minister's Hibiscus Award 2014/2015
Notable Achievement in
Environmental Performance



Top 10 Outstanding
SMEs - Ranked 3rd



Export Excellence
Award



Product Excellence
Award



The BrandLaureate -
SMEs Chapter Awards 2010



Enterprise 50
Award 2009



7th
INTERNATIONAL
FURNITURE EXCELLENCE
AWARDS 2009

International Member of



Furniture Industry Research Association



Member of



malaysian interior industry partners association